

Parts Breakdown

Model RE-TH-0008-HC 58012

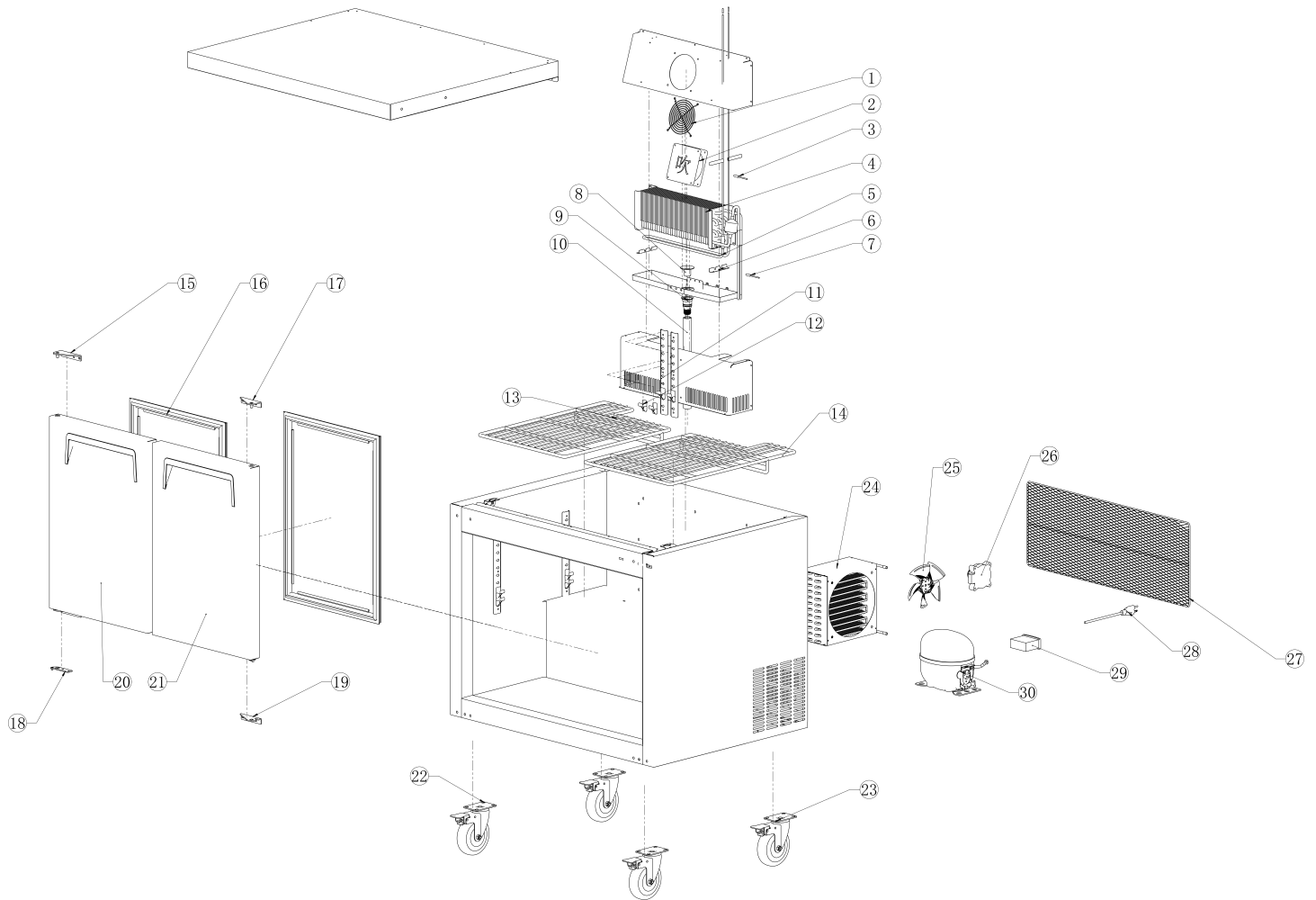

Parts Breakdown

Model RE-TH-0008-HC 58012

Item No.	Description	Position	Item No.	Description	Position	Item No.	Description	Position
AP919	Fan Stainless Steel Mesh Cover for 58012	1	AP950	Shelf (Left) for 58012	13	AP936	Universal Wheel (with Brake) for 58012	22
AP920	Evaporator Motor for 58012	2	AP951	Shelf (Right) for 58012	14	AP937	Universal Wheel (without Brake) for 58012	23
AP922	Evaporator for 58012	4	AP952	Top Hinge (Left) for 58012	15	AP938	Condenser (OD4.7x14520mm) for 58012	24
AP925	Temperature Sensor Probe (White) for 58012	7	AP953	Gasket for 58012	16	AP939	Fan Blade (EBM) for 58012	25
AP926	Drainage Outlet - Top for 58012	8	AP933	Top Hinge (Right) for 58012	17	AP940	Condenser Motor for 58012	26
AP927	Drainage Outlet - Bottom for 58012	9	AP954	Bottom Hinge (Left) for 58012	18	AP957	Mesh Plate (-AU09) for 58012	27
AP928	Outside Drain Pipe for 58012	10	AP934	Bottom Hinge (Right) for 58012	19	AP942	Power Cable (Black) for 58012	28
AP929	Ladder Strip for 58012	11	AP955	Doors Assembly (Left) for 58012	20	AP945	Controller (Dixell) 115V/60Hz for 58012	29
AP930	Grey K-Clip for 58012	12	AP956	Doors Assembly (Right) for 58012	21	AN293	Compressor (NUT55NR; 115-127V~60Hz R290) for 58012	30